

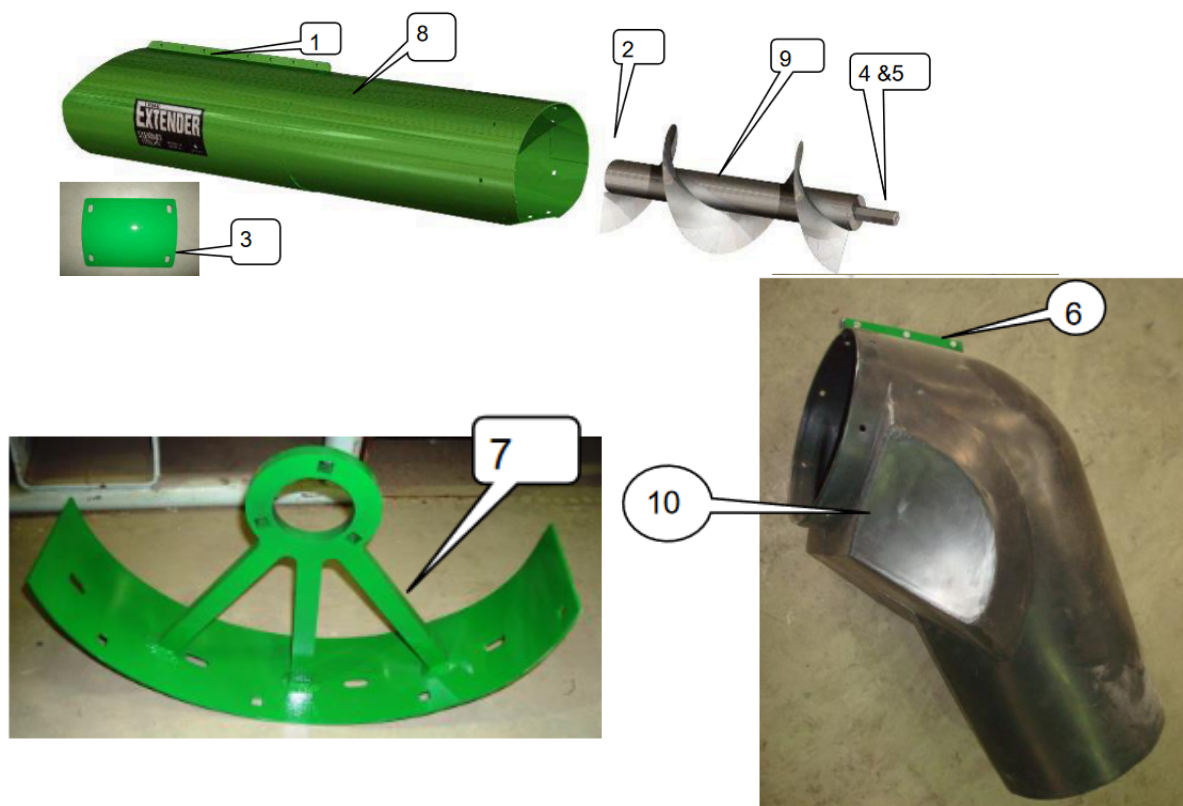

EJ603517 Spout

EJ603517 Spout



Hardware Kit consists of Items

1-6

1. Bolt Package BPKEJ70-14 (1)
2. Hex weld on Hub (1)
3. Inspection door (1)
4. Bearing & Collar AEL205-100D1 (1)
5. 52 MM flangettes (2)
6. Clamp support bracket (2)

Add hardware kit to items(14-16) in 72" box

7. Hanger Bracket (1)
8. Outer Tube/clamp (1)
9. Auger Unit (1)
10. Spout (1)

WARRANTY: STEWART STEEL INC. WARRANTY COVERS ALL THE ABOVE PARTS FOR A PERIOD OF 1 YEAR FROM TIME OF PURCHASE. THE WARRANTY DOES NOT COVER ANY PARTS MADE AND SOLD BY THE ORIGINAL MANUFACTURER OR ANY PARTS THAT WERE PART OF THE ORIGINAL COMBINE CONSTRUCTION.

* EXTENDING AUGER OVER MANUFACTURERS RECOMMENDED MAXIMUM LENGTH IS DONE AT CUSTOMERS OWN RISK

*** NEVER LEAVE UNLOADING AUGER FULL UNLESS ABSOLUTELY NECESSARY!**

EJ603517 Spout

Install Instructions EJ603517 Spout

1. Drill out 9 dimples on Spout with 3/8" drill bit (Figure 10)
2. Drill out 3 dimples on top squeeze clamp with 5/6" drill bit.
3. Mount spout by sliding bottom of spout over grain saver door and then by lifting end of spout upward until evenly over auger tube.
4. Line up 1 hole and start threading in 5/16" x 3/4" flanged hex bolts
5. Mount clamp support plates on either side of clamp with 1/4" x 2" bolts and locknuts. Tighten securely. (Figure 1)
6. Line up rest of holes and start threading in 5/16" x 3/4" flanged hex bolts and Securely tighten all nine 5/16" x 3/4" flanged hex bolts.
NOTE: When using original JD Spout break out weld in spot weld nuts by inserting a punch and bending over, replace original Carriage bolts and push nuts on tube. Secure spout down with original nuts

**NOTE: When installing spout as a replacement on factory auger replace 4 hanger bracket bolts with supplied 3/8 x 1-1/4 carriage bolts from outside in. This is necessary to allow spout to slide on to proper position.*

Figure 10

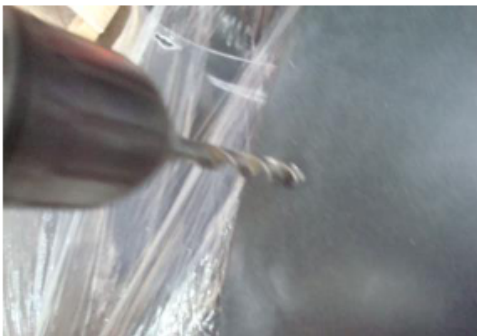

figure 11



WARRANTY: STEWART STEEL INC. WARRANTY COVERS ALL THE ABOVE PARTS FOR A PERIOD OF 1 YEAR FROM TIME OF PURCHASE. THE WARRANTY DOES NOT COVER ANY PARTS MADE AND SOLD BY THE ORIGINAL MANUFACTURER OR ANY PARTS THAT WERE PART OF THE ORIGINAL COMBINE CONSTRUCTION.

* EXTENDING AUGER OVER MANUFACTURERS RECOMMENDED MAXIMUM LENGTH IS DONE AT CUSTOMERS OWN RISK

*** NEVER LEAVE UNLOADING AUGER FULL UNLESS ABSOLUTELY NECESSARY!**

EJ603517 Spout
COMBINE UNLOADING AUGER EXTENSION FOR:
John Deere for Models 9660 to 9870STS

Installation Instructions:

1. Remove plastic spout and grain saver door. Remove 4 bolts that hold up bearing support at end of auger tube. Remove 8mm bolt in end of hex shaft. Save as they must be re-inserted after Extender tube is installed.

2. Slide on The EXTENDER's outer tube against the edge of the unloading auger's tube by sliding the sleeve portion over the present tube. Install all sleeve bolts loosely. Make sure bolts are at top of tube and that the 4 slots for the original bolts for the hanger bracket line up for the original hanger bracket. Re-install 4 bolts holding up factory hanger bracket loosely. Tighten clamp bolts on Extender tube first and then the 4 hanger bracket bolts. Install 5/16 x 3/4" bolts with locknuts from inside out on 6 holes(Figure 4) . This strengthens the band where the outer tube and sleeve are welded together.

3. Slide hex centre stub(Figure 5) on to end-shaft of auger until up against original bearing & hanger bracket. Replace factory 8mm Bolt and flat washer.(Figure 5) Tighten 2 set screws on hub. Slide extender auger in place with flighting approx. 180 degrees from the original auger.
THIS IS TO ALLOW THE GRAIN TO PASS THROUGH THE ORIGINAL HANGER BRACKET AND THEN GET PICKED UP BY THE OUTER AUGER

Slide auger on far enough to fit over flange on hub(Figure 6). Install 6 - gr-8 bolts and lock washers through flange on auger to hub. Do not tighten until step 4.

4. Mount new hanger bracket with 3/8" carriage bolts flat washers and locknuts. Mount bearing and flangettes at the outer end(on outside of hanger bracket) securing with locking collar to hold auger in proper place. Reach in through window and tighten 6 grade 8 x 3/8 bolts securely.(It would be advised to use locktite on these bolts as well.)

WARRANTY: STEWART STEEL INC. WARRANTY COVERS ALL THE ABOVE PARTS FOR A PERIOD OF 1 YEAR FROM TIME OF PURCHASE. THE WARRANTY DOES NOT COVER ANY PARTS MADE AND SOLD BY THE ORIGINAL MANUFACTURER OR ANY PARTS THAT WERE PART OF THE ORIGINAL COMBINE CONSTRUCTION.

* EXTENDING AUGER OVER MANUFACTURERS RECOMMENDED MAXIMUM LENGTH IS DONE AT CUSTOMERS OWN RISK

*** NEVER LEAVE UNLOADING AUGER FULL UNLESS ABSOLUTELY NECESSARY!**

EJ603517 Spout

5. Run auger to see if alignment is proper

Special Note: *If there is vibration in the auger after running it loosen the 6 - 3/8x 1 gr. 8 bolts, turn auger over a few times and retighten. Vibration should disappear.*

6. Replace factory grain saver door bracket up to its position in the end of the new auger tube.

7. Install plastic discharge spout in desired position using new hardware supplied (SEE FIGURE 10 & 11)

8. Mount inspection door by pushing 5/16 x 3/4 low shoulder carriage bolts through square bolt holes around inspection door from inside out and secure in place with push nuts. Then secure door with 4 - 5/16 wing nuts supplied. (Figure7)(Figure8)(Figure9)

Figure 4

Rear Hex Hub

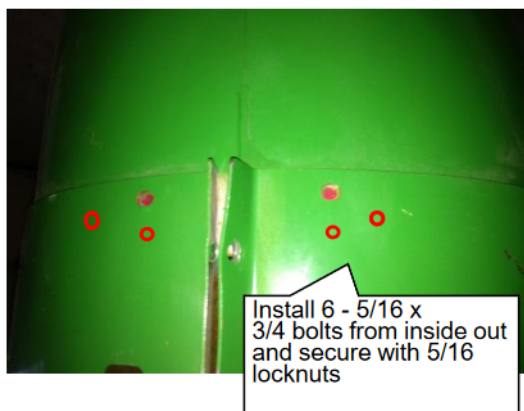
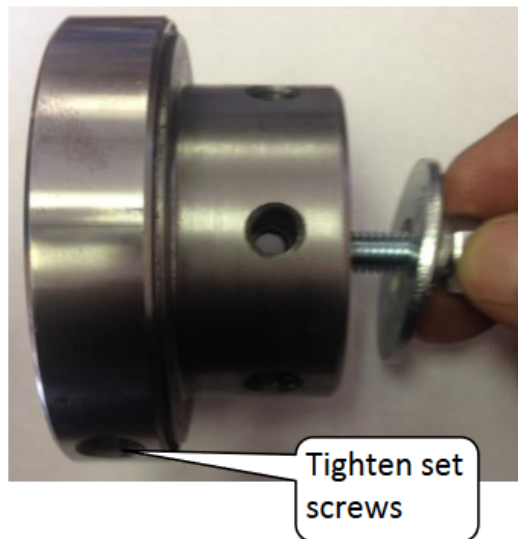

figure 5



WARRANTY: STEWART STEEL INC. WARRANTY COVERS ALL THE ABOVE PARTS FOR A PERIOD OF 1 YEAR FROM TIME OF PURCHASE. THE WARRANTY DOES NOT COVER ANY PARTS MADE AND SOLD BY THE ORIGINAL MANUFACTURER OR ANY PARTS THAT WERE PART OF THE ORIGINAL COMBINE CONSTRUCTION.

* EXTENDING AUGER OVER MANUFACTURERS RECOMMENDED MAXIMUM LENGTH IS DONE AT CUSTOMERS OWN RISK

*** NEVER LEAVE UNLOADING AUGER FULL UNLESS ABSOLUTELY NECESSARY!**

EJ603517 Spout



Figure 6



figure 7

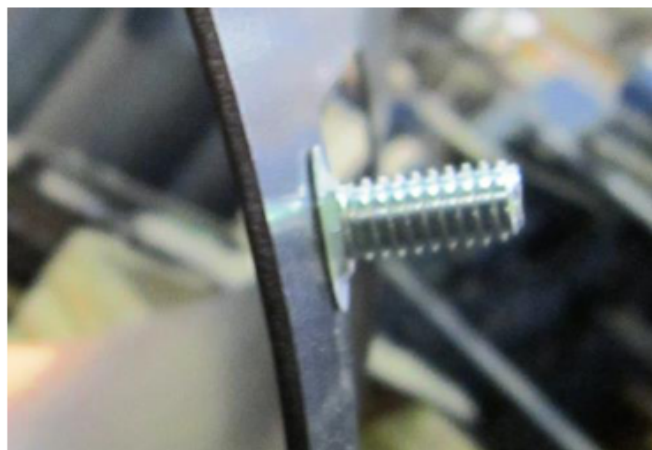

figure 8



Figure 9



WARRANTY: STEWART STEEL INC. WARRANTY COVERS ALL THE ABOVE PARTS FOR A PERIOD OF 1 YEAR FROM TIME OF PURCHASE. THE WARRANTY DOES NOT COVER ANY PARTS MADE AND SOLD BY THE ORIGINAL MANUFACTURER OR ANY PARTS THAT WERE PART OF THE ORIGINAL COMBINE CONSTRUCTION.

* EXTENDING AUGER OVER MANUFACTURERS RECOMMENDED MAXIMUM LENGTH IS DONE AT CUSTOMERS OWN RISK

*** NEVER LEAVE UNLOADING AUGER FULL UNLESS ABSOLUTELY NECESSARY!**